

50

49

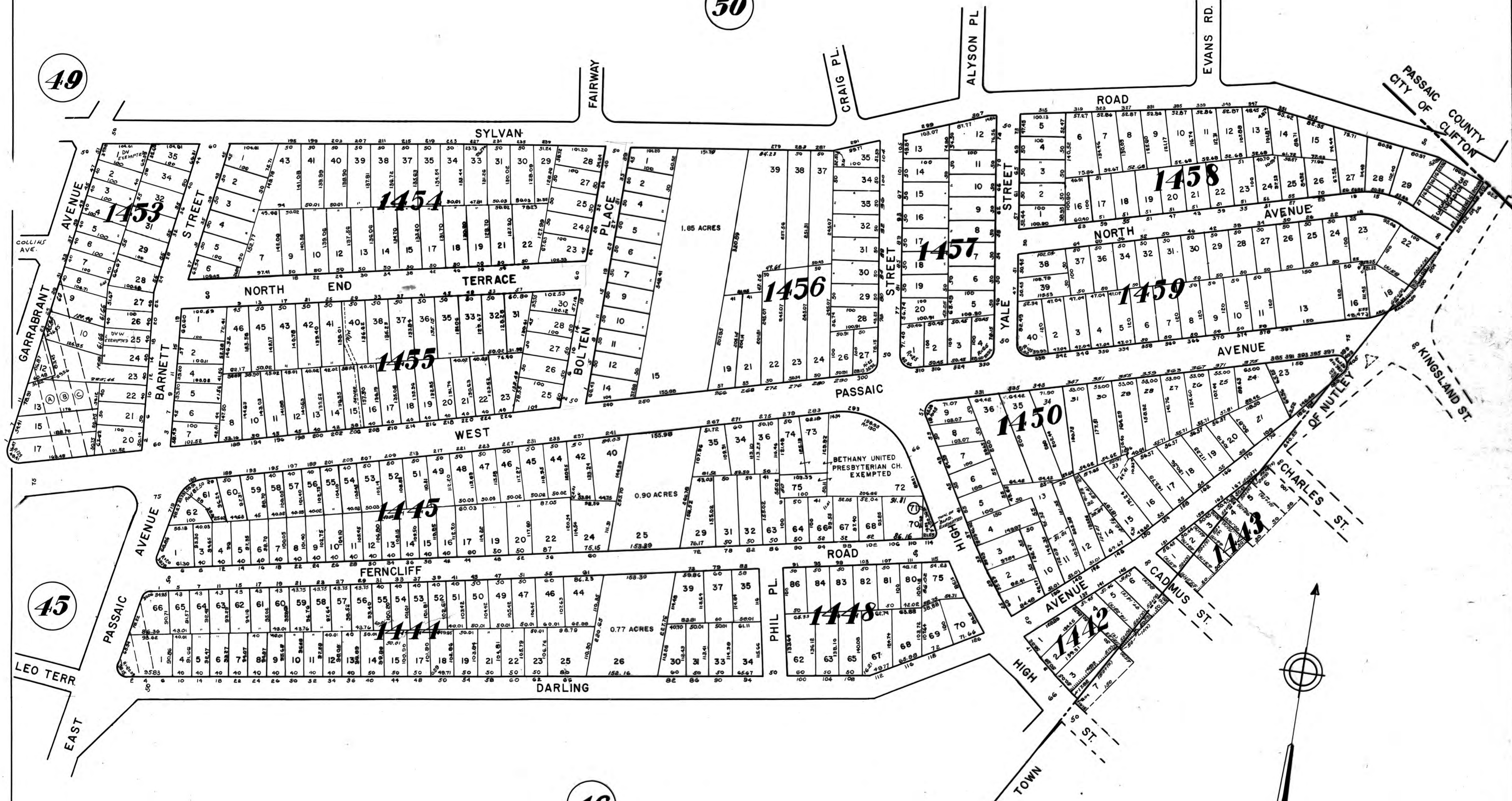

45

46

41

NOTE:
 (a) NEWARK RIGHT OF WAY
 NO. JERSEY DIST. WATER SUPPLY COMM. AND
 PASSAIC VALLEY WATER COMMISSION ARE
 SUB-SURFACE RIGHTS

TAX MAP
 TOWN OF BLOOMFIELD
 ESSEX COUNTY, N. J.
 OFFICE OF TOWN ENGINEER
 JAN 1928 SCALE 1" = 100 FEET
 REVISED TO: OCT. 1965
 As of Jan. 31, 1973
 " " May 17, 1974
 " " Mar. 11, 1979